



Be Sure
to Read this
Manual
Before Use



Operation Manual



www.universal-space.com

CONTENT

IMPORTANT SAFETY INSTRUCTIONS.....	2
1. SPECIFICATIONS.....	4
2. PACKAGE CONTENTS.....	5
3. PART NAMES	6
4. SET UP & INSTALLATION.....	7
5. HOW TO PLAY	10
6. MAINTENANCE & INSPECTION.....	11
7. OVERALL CONSTRUCTION.....	12
8. WIRING DIAGRAM.....	28



WARNING

Non-technical personnel who do not have technical knowledge and Expertise should refrain from performing such work that this manual require or perform tasks which are not explained in this manual. Failing to comply can cause severe accidents such as electric shock or other serious injuries. All repairs must be performed to original manufacturer specifications.

WARNING: To reduce the risk of fire, electric shock or personal injury, unplug or disconnect the machine from the power supply before servicing.

Thank you for purchasing **Seaway Submarine**. We hope you enjoy the product.

This manual contains valuable information about how to operate and maintain your game machine properly and safely. It is intended for the owner and/or personnel in charge of product operation. Carefully read and understand the instructions.

If you need any help during installation and setup please utilize this manual and troubleshooting guide. If the product fails to function properly, *non-technical personnel should under no circumstance attempt to service the machine*. Contact your distributor or manufacturer for help.

Before use, please read **IMPORTANT SAFETY INSTRUCTIONS**.

IMPORTANT SAFETY INSTRUCTIONS

To ensure the safe usage of this product, carefully read and understand these instructions before operating your game.

Save these instructions for future reference.

Use this product only as described in this manual. Other uses not recommended may cause fire, electric shock or personal injury. Unplug the game from the outlet when not in use, when moving from one location to another, and before cleaning/servicing.

Explanations which require special attention are indicated by signs of warning. Depending on the potential hazardous degree, the terms: **NOTE**, **NOTICE**, and **WARNING** are used.

NOTE: A NOTE indicates useful hints or information about product usage.

NOTICE: A NOTICE indicates potential damage to product and how to avoid the problem.

WARNING: A WARNING indicates a potential for product damage or serious personal Injury.

It is important to understand the meaning of the following **HAZARD SIGNS** before continuing:

High Voltage and Shock Hazard:

High voltage can cause electric shock.

Turn off/unplug power before servicing.



High Temperature Hazard:

This part may cause scalding.

Do not touch. Surface may be hot.



No Touching Hazard:

This part may be hot or can cause electric shock.

Do not touch.



Use the following safety guidelines to help ensure your own personal safety and to help protect your equipment and surrounding environment from potential damage.



This product is an indoor game machine. Do not install outdoors.

Avoid installing in the following places to prevent fire, electric shock, injury and/or machine malfunctioning:

- Places subject to rain/moisture, or places subject to high humidity.
- Places subject to direct sunlight, or places subject to extremely hot or cold temperatures to ensure that it is used within the specified operating range.
- Places where inflammable gas may be present or in the vicinity of highly inflammable/volatile chemicals or items that can easily catch fire
- On unstable or sloped surfaces. The machine may topple or cause unforeseen accidents.
- Vicinity of fire exits, fire extinguishers etc that may block/prevent safety measures

IMPORTANT NOTE:

ALL REPAIRS MUST BE DONE TO ORIGINAL MANUFACTURER SPECIFICATIONS.

FAILURE TO DO SO VOID ALL WARRANTIES AND OPERATOR ASSUMES ALL RISKS.

Note: The contents of this manual may be updated without notice

1. SPECIFICATIONS

Rated power supply: 110V, 50/60Hz

Min. Power consumption: 90W

Max. Power consumption: 380W

Dimensions: W1185×D1981×H1891 (mm)

Weight: Approximately 400KG

⚠ NOTICE: After turning off the game, please wait at least 1 minute before restarting again.

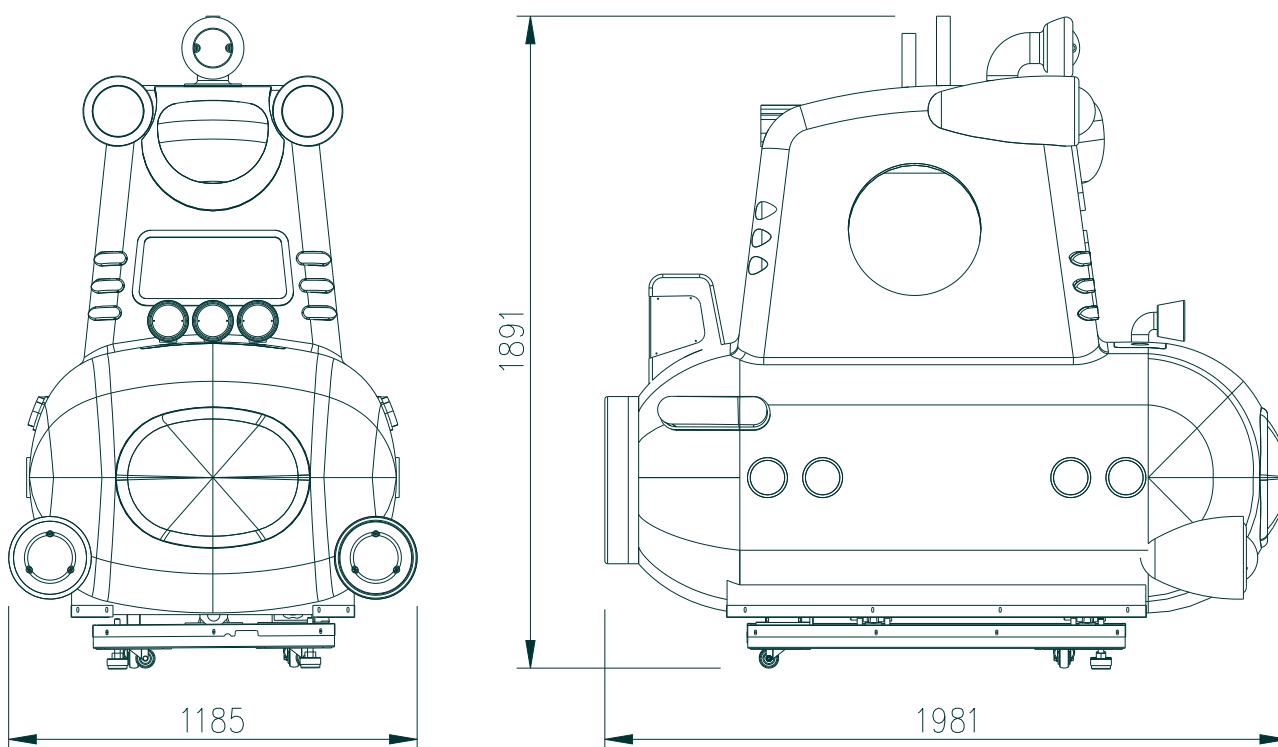

Note: Game parameters are subject to change without notice.

⚠ NOTICE: After turning off the game, please wait at least 1 minute before restarting again.

2. PACKAGE CONTENTS

Open the package and make sure all the items are included:

- 1 x Body Assembly

No.	Part No.	Draw No.	Name	SPEC.	Qty
1	S119-401-000	21901000014	Fuse	Φ6×30mm T10A 250VAC	1
2	S119-402-000	22402000201	Catch fish button	57-1820-02 white	1
3	S119-403-000	22401040003	Small button with light	Yellow Φ24 2428	1
4	S119-404-000	25300171002	Key	171	1
5	S119-405-000	25300172002	Key	171B	1

- Following accessories

If any items are found to be missing, please contact your sales representative for help immediately.

NOTE: Part models are subject to change without notice.

3. PART NAMES

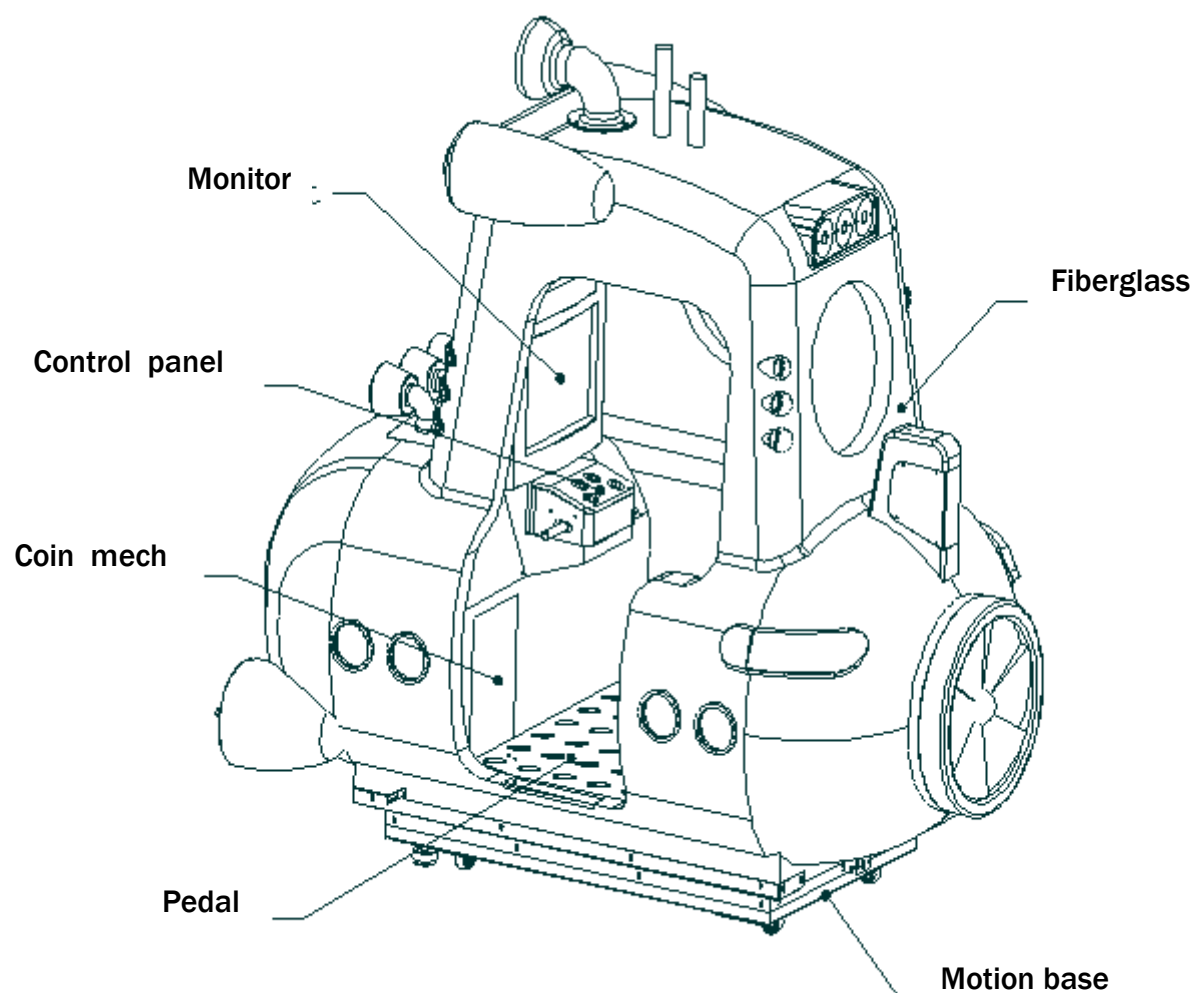

4. SET UP & INSTALLATION

 **This product is an indoor game machine. Do not install outdoors.**

- Refer to IMPORTANT SAFETY INSTRUCTIONS (Pg. 2) for places to avoid
- Place the unit on a dry level surface
- Ventilation openings in the back of the unit must not be obstructed by objects or by wall.

4.1 Play Zone

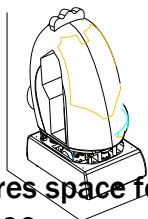

This machine requires space for playing and for maintenance as shown below.

Play area: 100cm

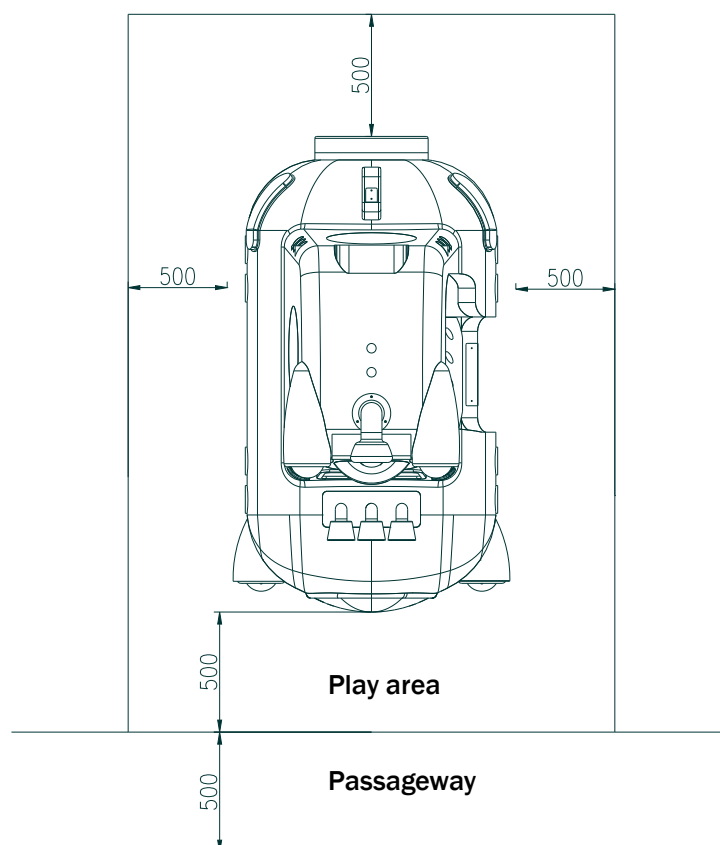

4.2 Level Adjustment

Install this machine on a flat surface. Adjust levers to lift casters off the ground to level the game. If the game is installed on an unsuitable floor, it could cause game malfunction.

To secure the game, adjust the Leveler down until it touches the floor, lifting the casters off the ground by 5mm. Repeat the same for all levelers.

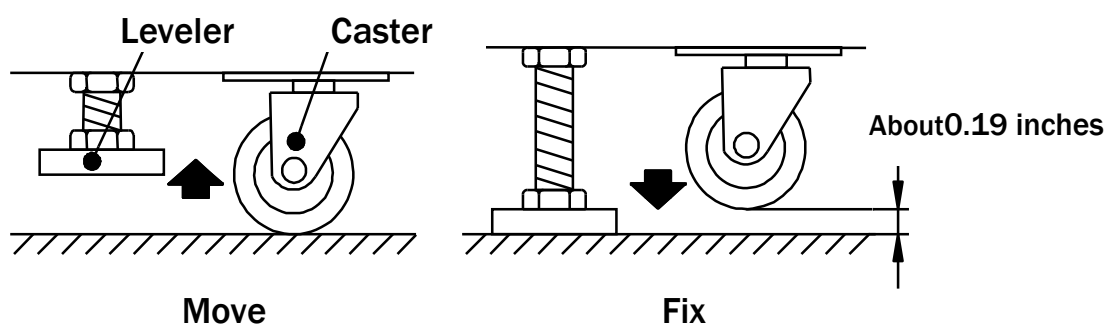

NOTICE

Make sure the machine is level with the ground and all the adjustable legs should stick to the floor closely.

4.3 Transporting the Game

If you need to move the game, adjust the levelers back to an “up” position so the casters touch the ground. The bedplate of the machine is provided with two wheels in its rear side. On a level surface the machine can be moved by using a trolley.

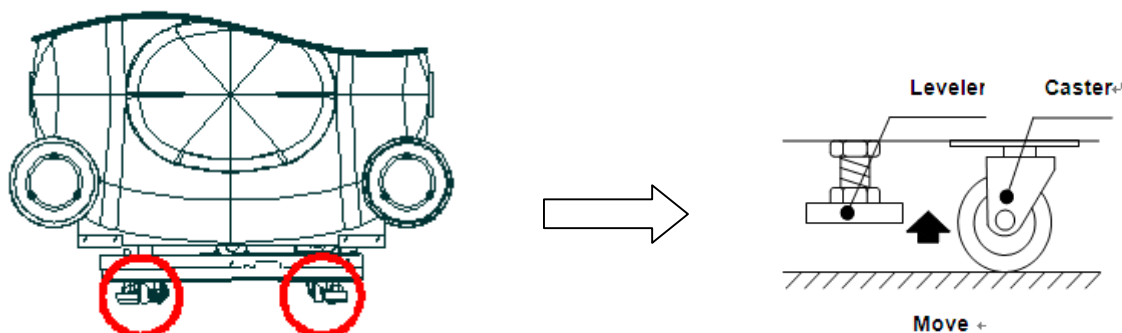

NOTICE

- Be careful not to damage the machine during transport.
- The machine should be handled with care when bringing it down from a higher level.
- Always unplug the game before moving.
- Keep the machine in upright position during transport.
- For longer distance transport, package the game properly to prevent damages

4.4 Connecting Power

⚠ WARNING: Check the voltage rating before you connect the equipment to an electrical outlet to ensure that the required voltage and frequency match the available power source. Please refer the label of the machine.

- Do not plug the equipment power cables into an electrical outlet if the power cable is damaged.
- Avoid putting many loads on one electrical outlet as it could generate heat and fire resulting from overload.
- Connect the grounding conductor to the earth terminal (GND):

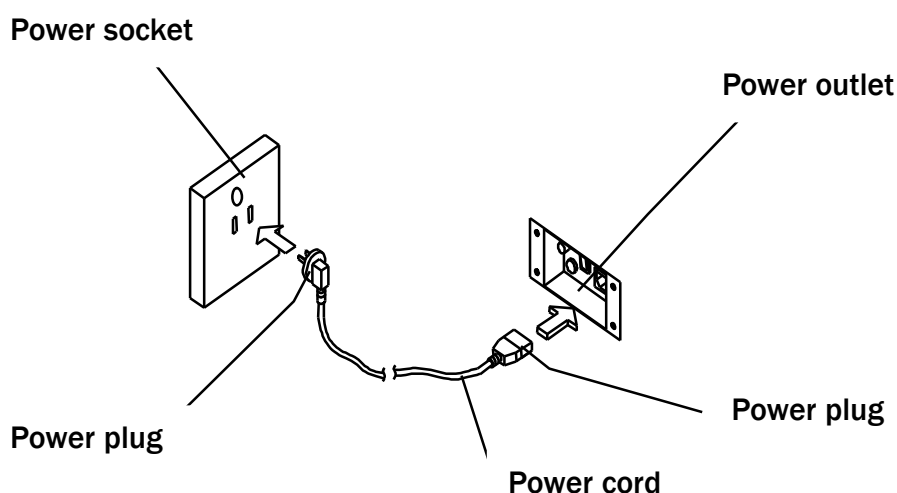

⚠ WARNING

Ensure no heavy objects rest on the power cord. Check to make sure the game cabinet does not sit on the power cord as this could damage the cord and become hazardous.

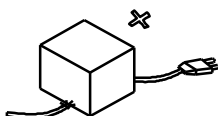

To disconnect the game, grip the plug and pull it from the wall outlet. Never pull by the cord.

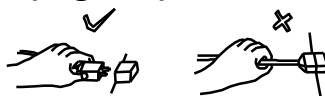

To prevent electric shock, do not touch the power plug when hand is wet.



Ensure that nothing rests on the power cord and that it is not located where it can be stepped on or tripped over.



5. HOW TO PLAY

Insert coins to begin your adventure!

Explore the ocean floor in your submarine.

Capture interesting sea creatures to learn more about them.

Change the color of your submarine and try out some special effects.

Happy Sai



CHANGE SUBMARINE
COLOR

SPECIAL EFFECT

ACCELERATE

CATCH FISH



6. MAINTENANCE & INSPECTION

6.1 Safety Check

Check the points listed before operating the machine. These checks are necessary for safe machine operation:

1. Try to run the game before operation each day.
2. Conduct monthly routine checks of game components ensure good working condition
3. Check the machine regularly for dust and clean when necessary.

Note: Parts and components require preventative maintenance to be kept running smoothly

6.2 Handling Precautions

When installing or inspecting the machine, be very careful of the following points and pay attention to ensure that the player can enjoy the game safely.

Non-compliance with the following points or inappropriate handling running counter to the cautionary matters herein stated can cause personal injury or damage to the machine



WARNING

- Before servicing the machine, be sure to turn power off. Servicing without turning the power off can cause electric shock or short circuit.
- To avoid electric shock or short circuit, do not plug then unplug the power quickly
- Do not expose power cords and earth wires, these are susceptible to damage.
- Damaged cords and wires can cause electric shock or short circuit and should be replaced immediately.
- When or after installing the product, avoid pulling the power cord to prevent unnecessary wear and tear. Use the power button to disconnect power.
- In case the power cord is damaged, ask for replacement through where the product was purchased from or replace locally. Continued usage of damaged cord can cause fire, electric shock or leakage.
- Perform grounding appropriately. Inappropriate grounding can cause electric shock.
- Use fuses that meet specified rating. Fuses exceeding can cause an electric shock.
- Should a problem occur, turn off the power immediately and stop operating the machine. Unplug the power cord of the service outlet. Operating the machine without correcting the problem may cause a fire or injuries.
- Insert the power plug securely into the outlet. Poor contact may cause overheating, resulting in fire or burns.
- To ensure the warning labels attached on the machine are visible and legible, install the machine in a well-lit location, and keep the labels clean at all times. Make sure the labels are not hidden behind other game machines.

7. OVERALL CONSTRUCTION

7.1 Base mechanism 1

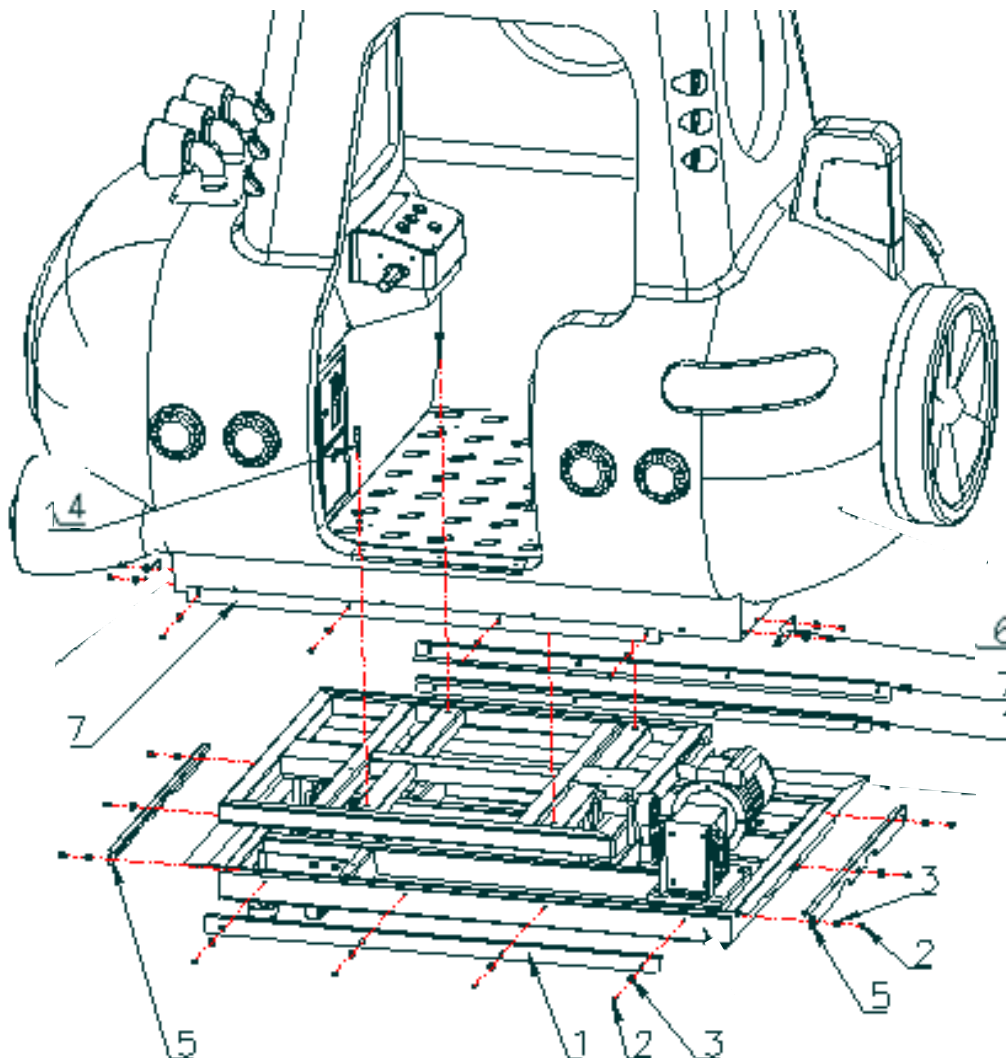

No.	Part No.	Code	Name	Material	Qty
1	S119-1480-000	20251302068	Skirt metal strip A	Q235	2
2	S119-301-000	20101010029	Cross recessed pan head screws	Q235	1
3	S119-302-000	20113010053	C class flat washer	Q235	30
4	S119-342-000	20101048007	Hexagon flat round head screw	Q235	4
5	S119-149-000	20251302069	Skirt metal strip B	Q235	2
6	S119-151-000	20251302071	Skirt metal strip D	Q235	4
7	S119-150-000	20251302070	Skirt metal strip C	Q235	2

7.2 Base mechanism 2

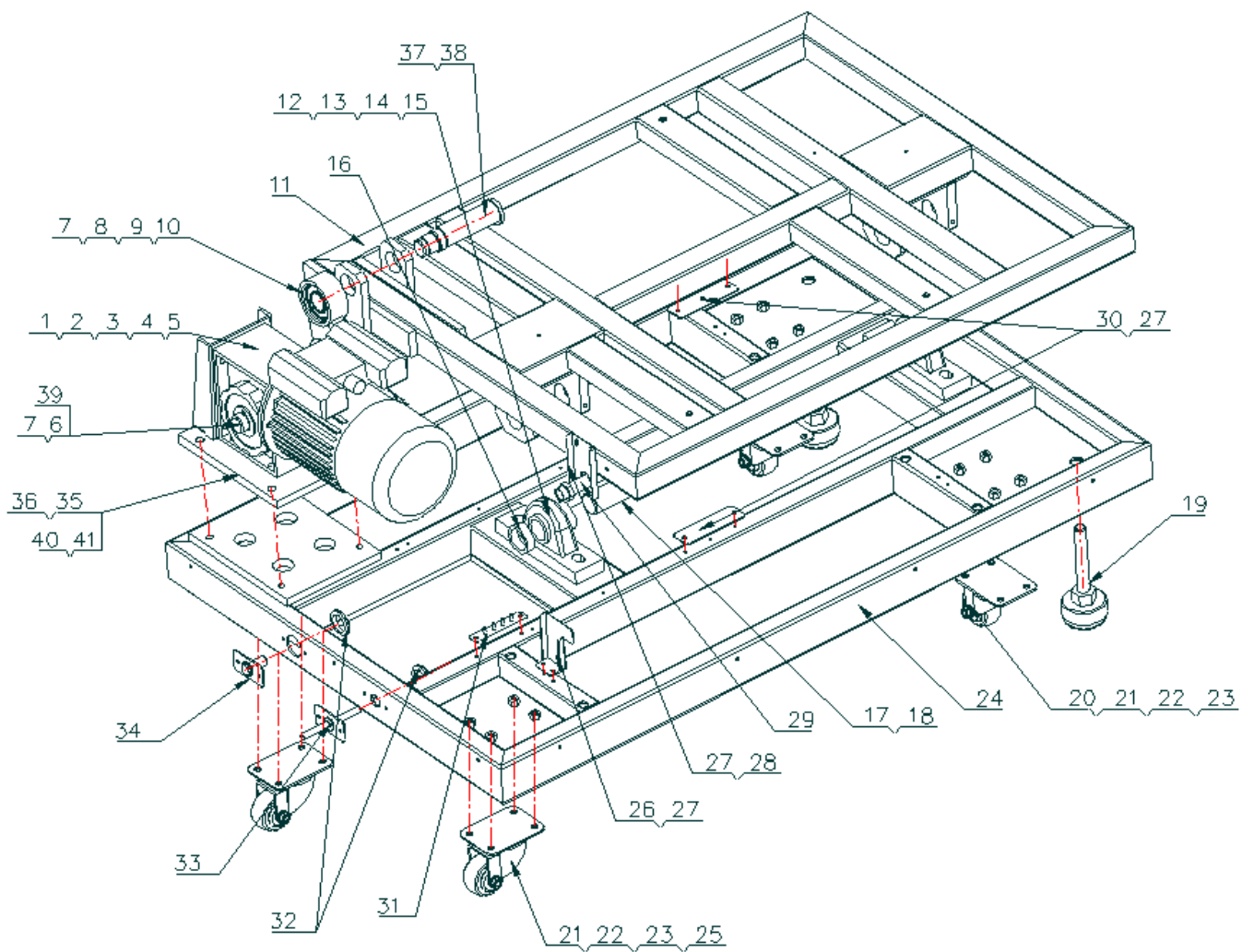

No.	Part No.	Code	Name	Material	Qty
1	S119-458-000	23405010010	Motor		1
2	S119-303-000	20104040030	Hexagon bolt		1
3	S119-304-000	20113000005	Standard spring washer		8
4	S119-305-000	20113000051	C class flat washer		8
5	S119-306-000	20102000013	Hexagon nut	Q235	8
6	S119-101-000	20251302027	Eccentric shaft	45#	1
7	S119-465-000	20105000197	A type circlip for shaft		3
8	S119-102-000	20251302026	Connected plate		1
9	S119-459-000	20106000057	Deep groove BD.		2
10	S119-466-000	20105000210	A type circlip for hole		2
11	S119-103-000	20251302072	Movable flame		1
12	S119-460-000	20106130158	Ball BD with seat		2
13	S119-309-000	20104031004	Hexagon bolt	Q235	4
14	S119-310-000	20113000004	Standard spring washer	Q235	4
15	S119-311-000	20113000054	C class flat washer	Q235	4
16	S119-104-000	20251302025	Shaft sleeve	Q235	2
17	S119-105-000	20251302024	Connecting shaft	45#	2
18	S119-467-000	20107000116	Cotter pin		2
19	S119-106-000	26000008000	Leveler	Q235	2
20	S119-461-000	20851302003	Caster		2
21	S119-313-000	20104100030	Hexagon bolt	Stainless steel	16
22	S119-305-000	20113000051	C class flat washer		8
23	S119-304-000	20113000005	Standard spring washer		8
24	S119-107-000	20251302073	Basic frame	Q235	1
25	S119-462-000	20851302002	Rigid caster		2
26	S119-108-000	20251302028	Reset part	Q235	1
27	S119-314-000	20101000024	Cross recessed pan head screws		8
28	S119-109-000	20251302029	Reset switch bracket	Q235	1
29	S119-449-000	21501000004	Sensor		1
30	S119-110-000	20651302001	Insulating spacer	PVC	2
31	S119-111-000	20251302031	Grounded plate	Metal	2
32	S119-454-000	23313000265	Bushings		2
33	S119-112-000	20251302A001	Cable fixed plate	202 steel	1
34	S119-113-000	20251302033	Fuse mounted plate	202 steel	1
35	S119-114-000	20251302034	Mtor mounted bracket	Q235	1
36	S119-315-000	20104000008	Hexagon bolt	Q235	4
37	S119-115-000	20251302035	Connected rod	45#	1
38	S119-468-000	20105000024	A type circlip for shaft		1
39	S119-116-000	20251302030	General flat key	45#	1
40	S119-317-000	20113000102	Standard spring washer	Q235	4
41	S119-318-000	20113000052	C class flat washer		4

7.4 Main Body Part 1

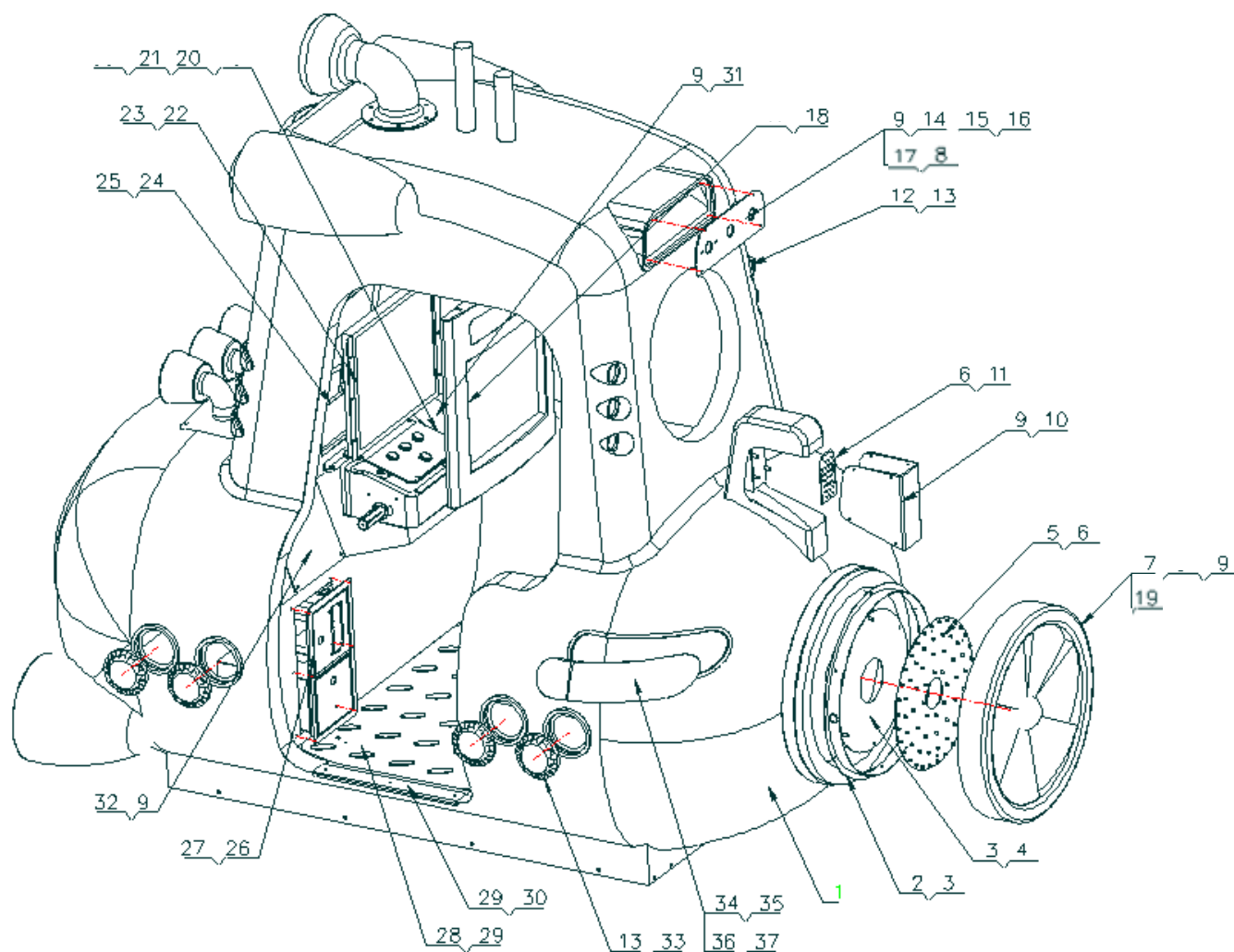

No.	Part No.	Code	Name	Material	Qty
1	S119-606-000	20651302002	Fiberglass body	Fiberglass	1
2	S119-117-000	20251302039	propellers plate	Q235	1
3	S119-319-000	20103020001	Cross recessed pan head self-tapping screw	Q235	6
4	S119-118-000	20251302040	Propellers light mounted plate	Q235	1
5	S119-417-000	29751302003	Propellers light board		1
6	S119-320-000	20101000021	Cross recessed pan head screws		8
7	S119-601-000	20651302003	Propellers light cover	White plastic	1
8	S119-445-000	22204060002	Upper orange light cover with socket		1
9	S119-321-000	20101000006	Hexagon flat round head screw		23
10	S119-602-000	20651302004	Spoiler light cover	White plastic	1
11	S119-413-000	29741003001	Spoiler light board		1
12	S119-439-000	22204030008	Side upper light cover	Violet	6
13	S119-322-000	20103020008	Cross recessed pan head self-tapping screw	Q235	12
14	S119-603-000	20651302005	Back upper light cover	plastic	1
15	S119-442-000	22204060001	Upper green light cover with socket		1
16	S119-323-000	20101000048	Cross recessed pan head screws		16
17	S119-444-000	22003020003	Upper white light		1

No.	Part No.	Code	Name	Material.	Qty
18	S119-326-000	20101000052	Cross recessed pan head screws		4
19	S119-341-000	20113000055	C class flat washer	Q235	3
20	S119-337-000	20101000202	Cross recessed pan head bolt suite	Q235	4
21	S119-321-000	20101000006	Hexagon flat round head screw		4
22	S119-436-000	21201017003	17" monitor		1
23	S119-324-000	20101000025	Cross recessed pan head screws		6
24	S119-119-000	20251302062	Monitor mounted plate	Q235	1
25	S119-338-000	20102000017	1 type hexagon nut	Q235	4
26	S119-001-000	26000031000	Coin door assy.		1
27	S119-339-000	20104000018	Round head square neck bolt		6
28	S119-120-000	20251302063	Foot rest plate	Aluminum plate	1
29	S119-340-000	20111000008	Flat round head blind rivet		7
30	S119-121-000	20251302064	Foot rest stainless steel plate	Stainless steel	1
31	S119-713-000	20551302007	Right side decal	Clear plastic	1
32	S119-712-000	20551302006	Left side decal	Clear plastic	1
33	S119-438-000	22204070001	Side round light cover		8
34	S119-604-000	20651302010	Side long strip light cover	White plastic	2
35	S119-336-000	20101000007	Hexagon flat round head screw		8
36	S119-605-000	20651302011	Side long strip light mounted plate	PVC	2
37	S119-322-000	20103020008	Cross recessed pan head self-tapping screw	Q235	12

7.5 Main Body Part 2

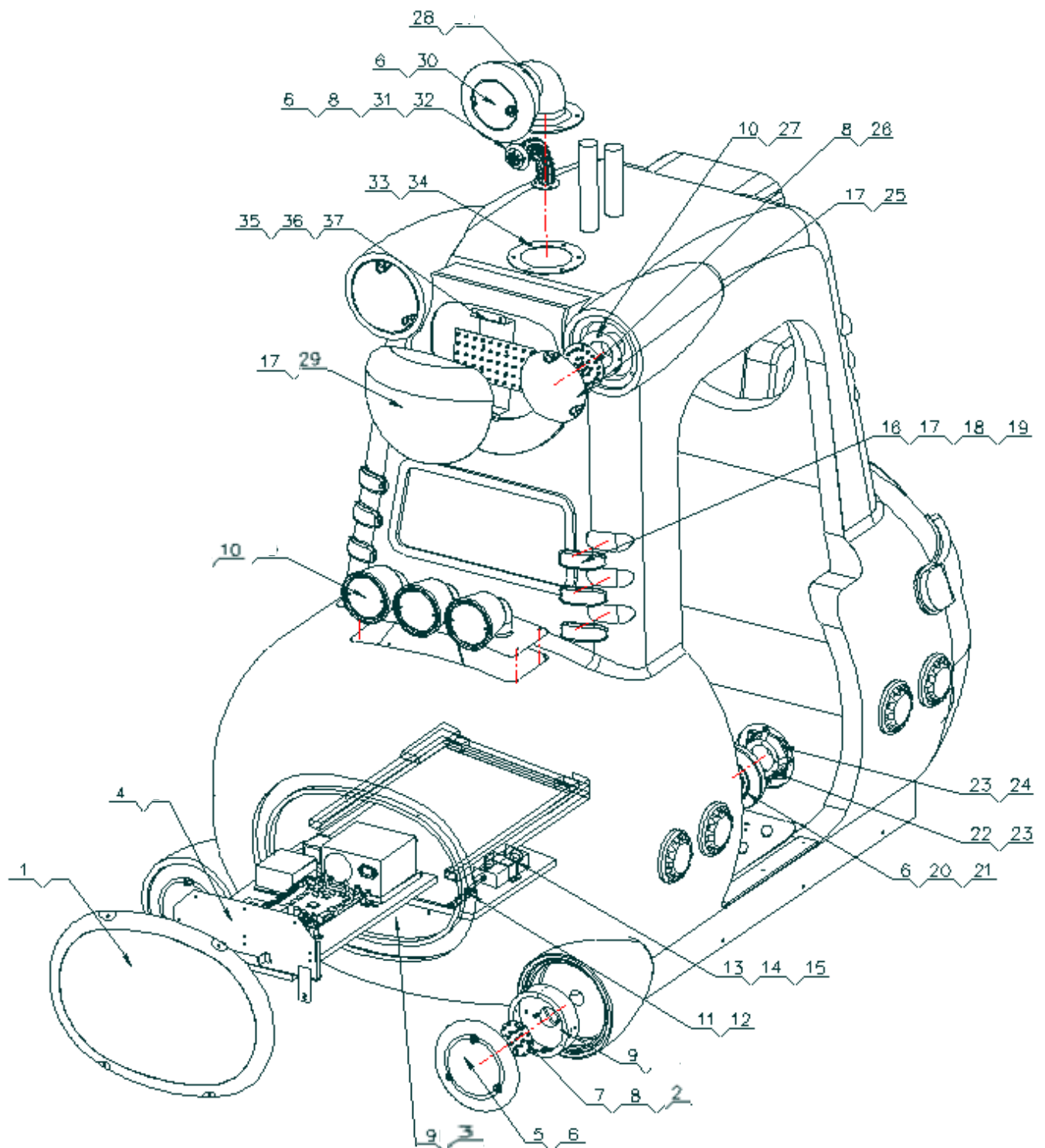

No.	Part No.	Code	Name	Material	Qty
1	S119-709-000	20551302002	Front head vacuum form	PET	1
2	S119-456-000	23313000266	Headlight bushings		3
3	S119-617-000	20651302022	Front head light mounted plate B	PVC	1
4	S119-321-000	20101000006	Hexagon flat round head screw		2
5	S119-710-000	20551302003	Headlight vacuum form cover	PET	2
6	S119-321-000	20101000006	Hexagon flat round head screw		6
7	S119-411-000	29710914004	Red LED board	red	2
8	S119-314-000	20101000024	Cross recessed pan head screws		12
9	S119-616-000	20651302021	Front head light mounted plate A	PVC	1
10	S119-619-000	20651302020	Searchlight fiberglass	Fiberglass	1
11	S119-111-000	20251302031	Grounded plate	Metal	1
12	S119-324-000	20101000025	Cross recessed pan head screws		2
13	S119-134-000	20251302080	Monitor power mounted bracket	Q235	1
14	S119-324-000	20101000025	Cross recessed pan head screws		2
15	S119-451-000	21602000076	DC power supply		1
16	S119-608-000	20651302013	Front side light cover	White plastic	6
17	S119-336-000	20101000007	Hexagon flat round head screw		12
18	S119-609-000	20651302014	Front side light mounted plate	PVC	6
19	S119-322-000	20103020008	Cross recessed pan head self-tapping screw	Q235	12
20	S119-610-000	20651302015	Speaker cover	White plastic	2
21	S119-135-000	20251302081	Speaker grill	Q235	2
22	S119-136-000	20251302082	Speaker light bracket	Q235	2
23	S119-324-000	20101000025	Cross recessed pan head screws		16
24	S119-448-000	22801000047	Speaker		1
25	S119-611-000	20651302016	Top side light cover	White plastic	2
26	S119-418-000	29751302004	Top side light blue		2
27	S119-137-000	20251302083	Top side light mounted plate	Q235	2
28	S119-612-000	20651302017	Periscope light	PE	1
29	S119-701-000	20551302A001	Top light vacuum form	plastic	1
30	S119-613-000	20651302018	Periscope light cover	red plastic	1
31	S119-138-000	20251302084	Periscope light bracket	Q235	1
32	S119-408-000	29751302002	Periscope red light board		1
33	S119-614-000	20251302085	Periscope light mounted plate	Q235	1
34	S119-340-000	20111000008	Flat round head blind rivet		3
35	S119-615-000	20651302019	Front light bracket	PVC	1
36	S119-322-000	20103020008	Cross recessed pan head self-tapping screw	Q235	4
37	S119-414-000	29740917007	Front light board	white	1

7.6 Control Panel Part

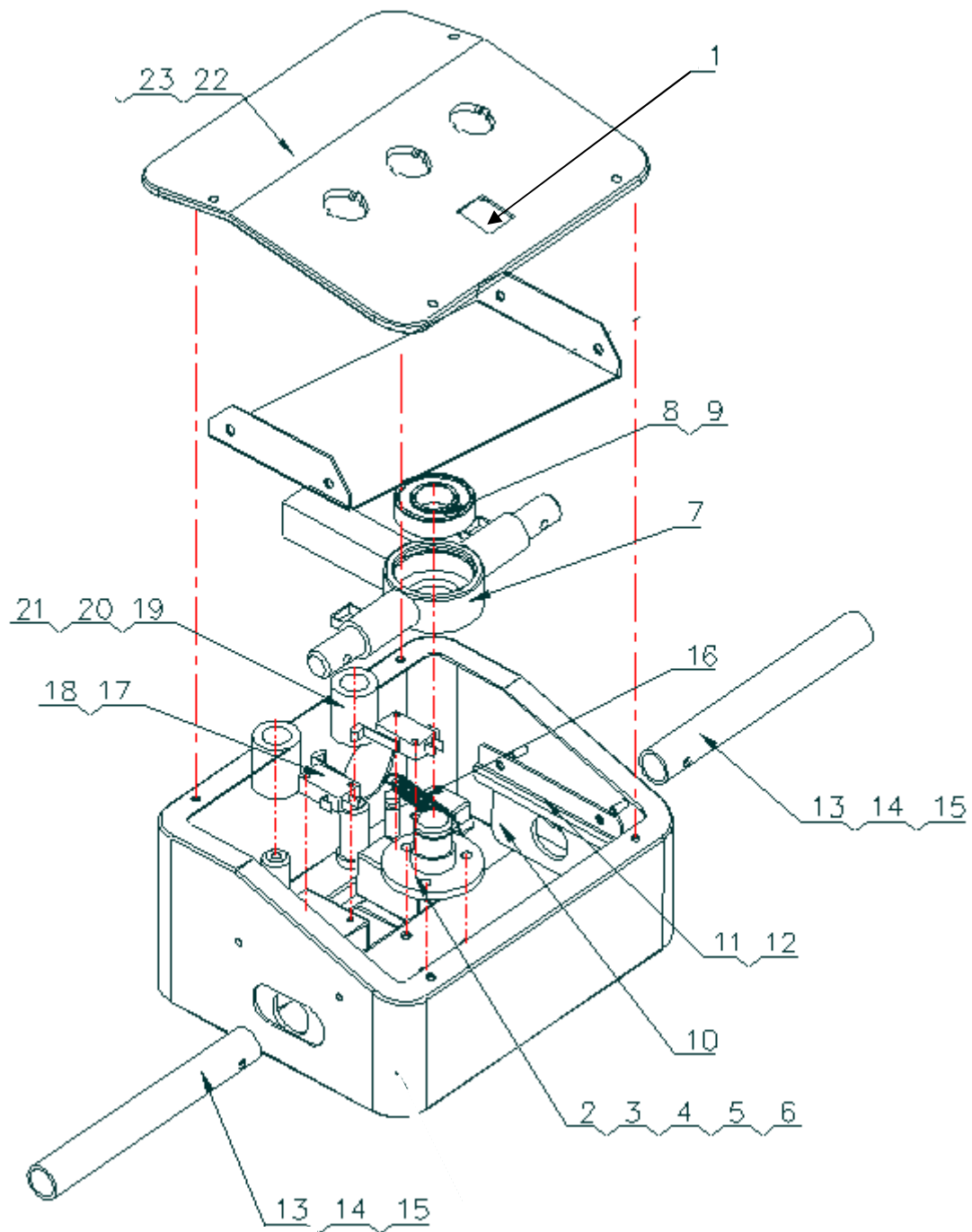

No.	Part No.	Code	Name	Material	Qty
1	S119-402-000	22402000201	Catch fish button		1
2	S119-128-000	20251302053	Locating shaft	Q235	1
3	S119-327-000	20101000011	Hexagon flat round head screw		3
4	S119-328-000	20113000056	C class flat washer	Q235	3
5	S119-329-000	20113000002	Standard spring washer		3
6	S119-330-000	20105010033	A type circlip for shaft		
7	S119-129-000	20251302054	Controlling part	Welding part	1
8	S119-463-000	20106000175	Deep groove BD.		1
9	S119-331-000	20105000211	A type circlip for hole		1
10	S119-607-000	20651302007	Protective plate	black plastic	2
11	S119-130-000	20251302059	Protective plate fixed plate	Q235	2
12	S119-332-000	20102030011	Hexagon nut with flange	Q235	4
13	S119-131-000	20251302060	Handle grip	Q235	2
14	S119-333-000	20101000013	Hexagon flat round head screw		2
15	S119-334-000	20102000030	Hexagon nut with flange		2
16	S119-132-000	20251302061	Reset tension spring	Spring steels	2
17	S119-452-000	22604000007	Micro SW		1
18	S119-323-000	20101000048	Cross recessed pan head screws		4
19	S119-133-000	20651302008	Limit rubber sleeve	PU	2
20	S119-335-000	20101108013	Hexagon flat round head screw	Stainless steel	2
21	S119-302-000	20113010053	C class flat washer	Q235	2
22	S119-702-000	20551302A002	Control panel decal	Clear plastic	1
23	S119-403-000	22401040003	Small yellow button w/light		3

7.7 Electrical box Part

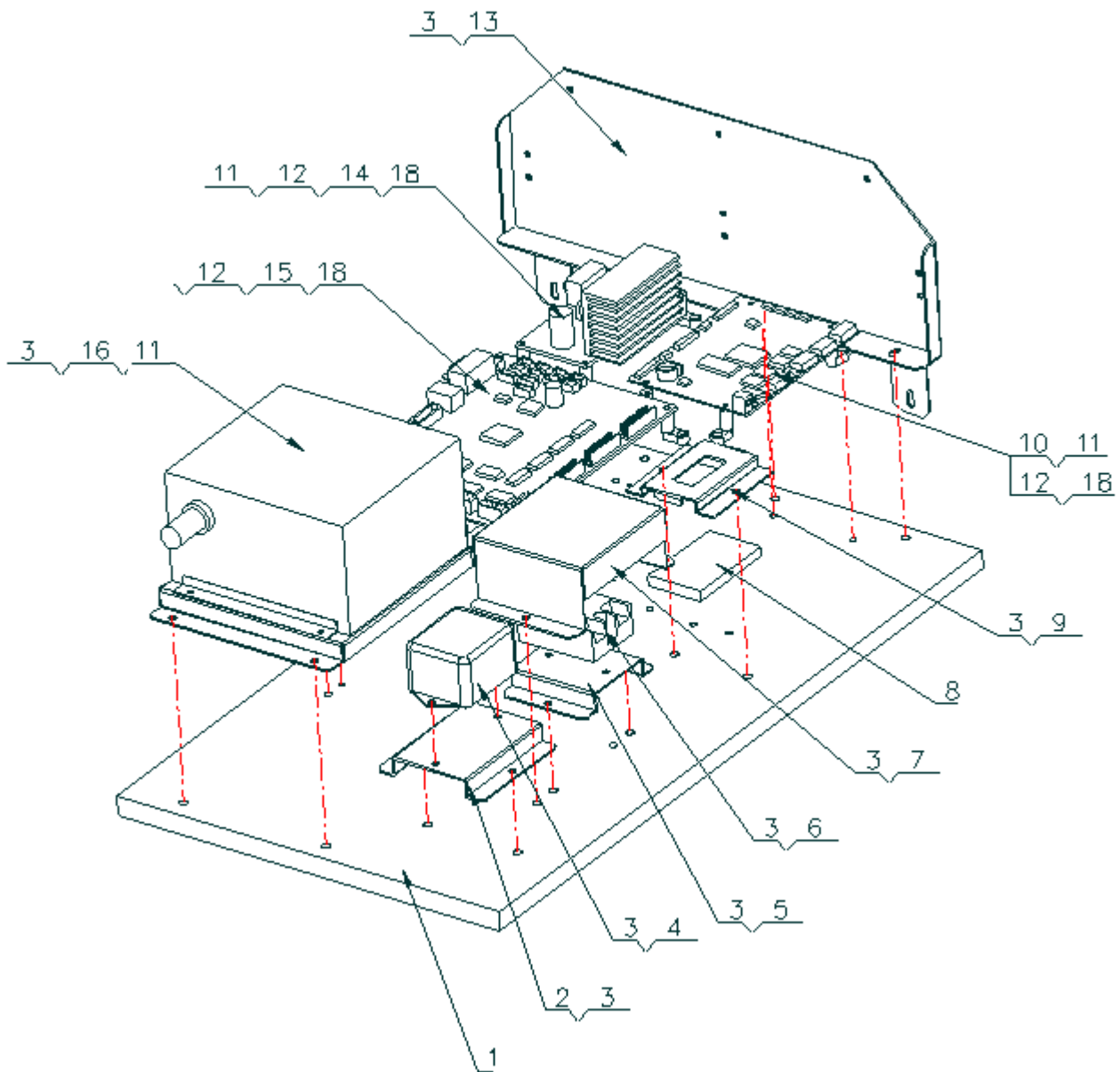

No.	Part No.	Code	Name	Material	Qty
1	S119-501-000	20351302003	Electrical box wooden plate	Plywood	1
2	S119-139-000	20251302074	Filter bracket	Q235	1
3	S119-314-000	20101000024	Cross recessed pan head screws		8
4	S119-450-000	23201000002	Filter		1
5	S119-140-000	20251302075	Solid state relay bracket	Q235	1
6	S119-430-000	22140000004	Solid state relay		1
7	S119-618-000	20651302012	Solid state relay cover	PC	1
8	S119-453-000	21107210019	Main board battery		1
9	S119-141-000	20251302076	Battery mounted bracket		1
10	S119-426-000	21107210007	Android board		1
11	S119-320-000	20101000021	Cross recessed pan head screws		8
12	S119-320-000	20101000021	Cross recessed pan head screws		8
13	S119-142-000	20251302077	Light mounted plate	Welding part	1
14	S119-429-000	22803000047	Amplifier		1
15	S119-143-000	26000032000	PC power fix bracket	Metal	1
16	S119-433-000	21602000001	Power supply		1

7.8 Electrical Part 1



No.	Part No.	Code	Name	Material	Qty
1	S119-445-000	22204060002	Upper orange light cover with socket		1
2	S119-439-000	22204030008	Side upper light cover	Violet	6
3	S119-413-000	29741003001	Spoiler light board		1
4	S119-406-000	22002013003	White LED light belt		3m
5	S119-436-000	21201017003	17" monitor		1
6	S119-410-000	22002013009	Front side green LED light belt		1m
7	S119-438-000	22204070001	Side round light cover		8
8	S119-442-000	22204060001	Upper green light cover with socket		1
9	S119-417-000	29751302003	Propellers light board		1

7.8 Electrical Part 1

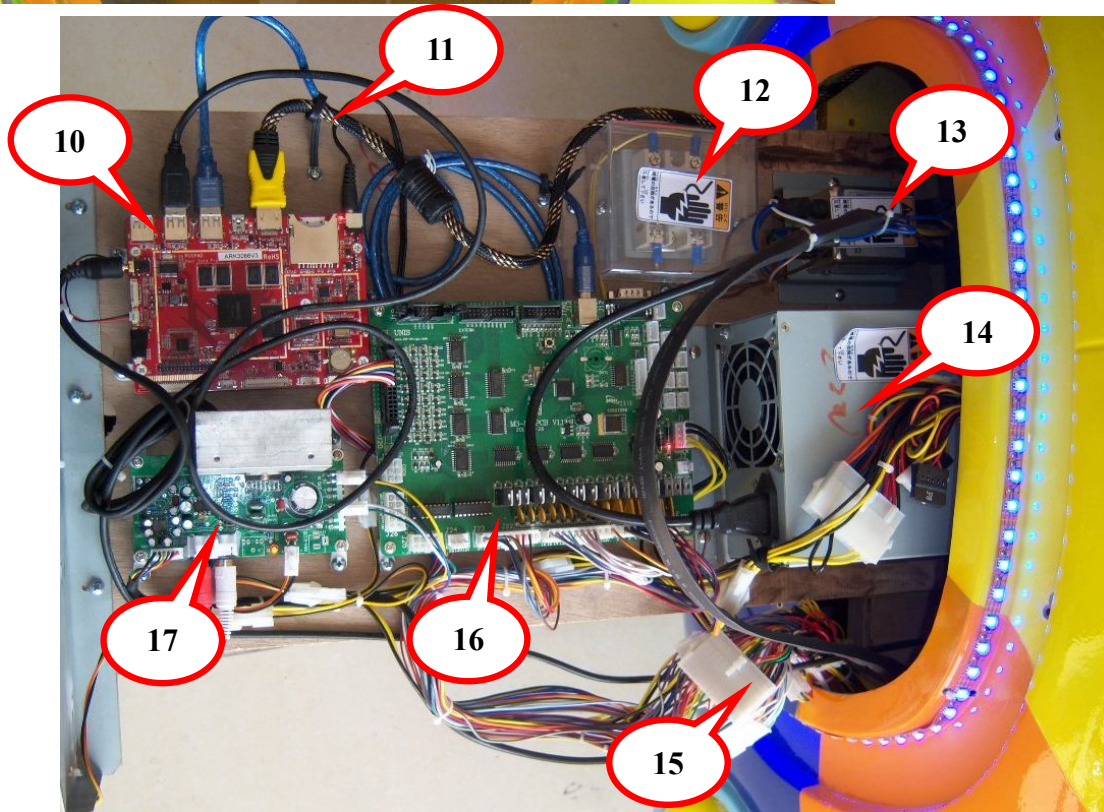
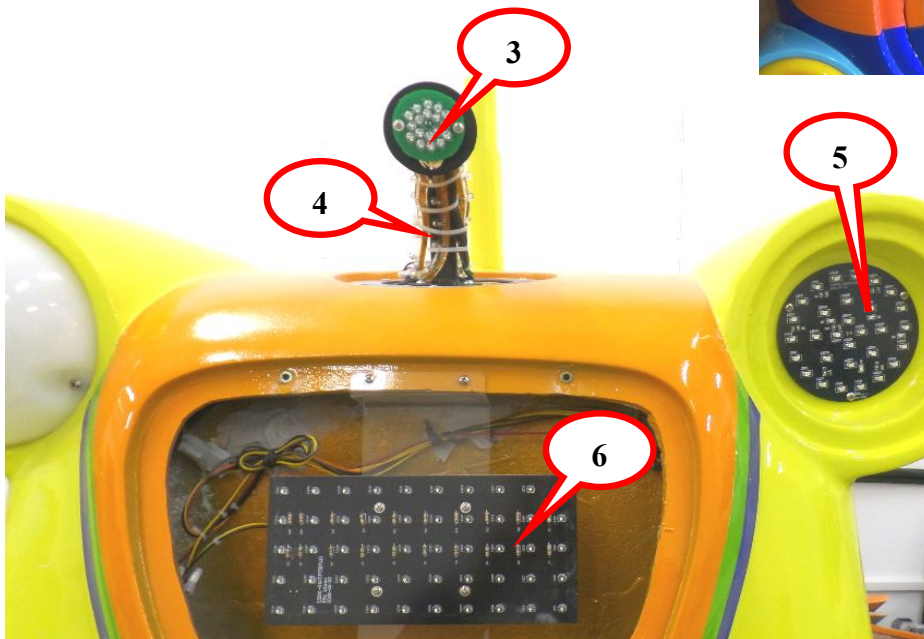
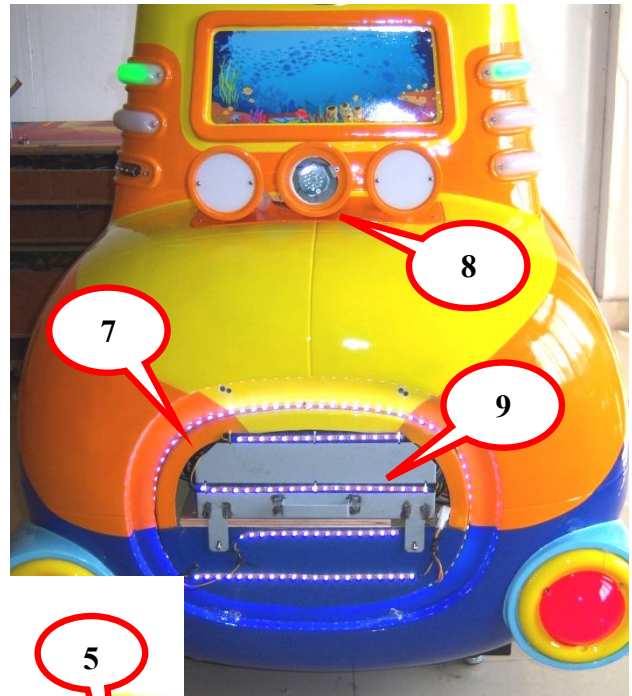
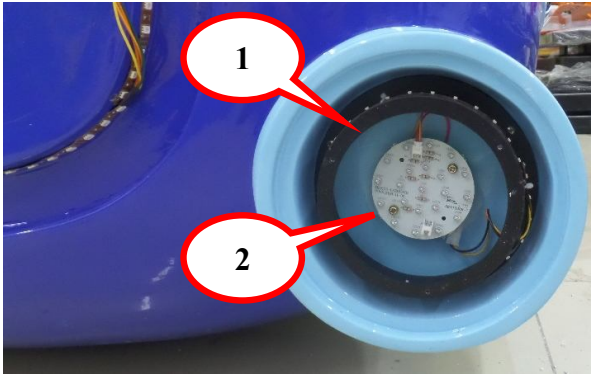

No.	Part No.	Code	Name	SPEC.	Qty
1	S119-406-000	22002013003	White LED light belt	DC12V 3528LED 60pcs/m white	3m
2	S119-411-000	29710914004	Red LED board	HHXYS-LED01.PCB(V1.0) red	2m
3	S119-408-000	29751302002	Periscope red light board	TJXS-PGLED.PCB/red	1
4	S119-416-000	22002017008	Periscope chain light	LTB-L240cm-LBDC12V(blue)150mm	4
5	S119-418-000	29751302004	Top side light blue	XYWCQ-LED01.PCB /blue	2
6	S119-414-000	29740917007	Front light board	XMJZ-LED01.PCB(V1.0) white	1
7	S119-412-000	22002013002	Front RGB light belt	DC12V 5050LED 3 color LED	1.5m
8	S119-407-000	29751302001	Front LED light board	TJXS-PGLED.PCB/ purple	3
9	S119-406-000	22002013003	White LED light belt	DC12V 3528LED 60pcs/m white	3m
10	S119-426-000	21107210007	Android board	ARB3066-V3	1
11	S119-419-000	23307010001	DVI-HDM video cable	DVI-HDMI(3.0M)	1
12	S119-430-000	22140000004	Solid state relay	SSR-40DA	1
13	S119-450-000	23201000002	Filter	YE20T4L2 20A	1
14	S119-451-000	21602000076	DC power supply	LYD (12V-4A) UL	1
15	S119-433-000	21602000001	Power supply	BTX-3039(110V220V)	1
16	S119-424-000	21701000029	Main board	M3_MB.PCB 150×200×2.0mm	1
17	S119-429-000	22803000047	Amplifier	GC-2.0-A(upgrade)	1

7.9 Decal Part

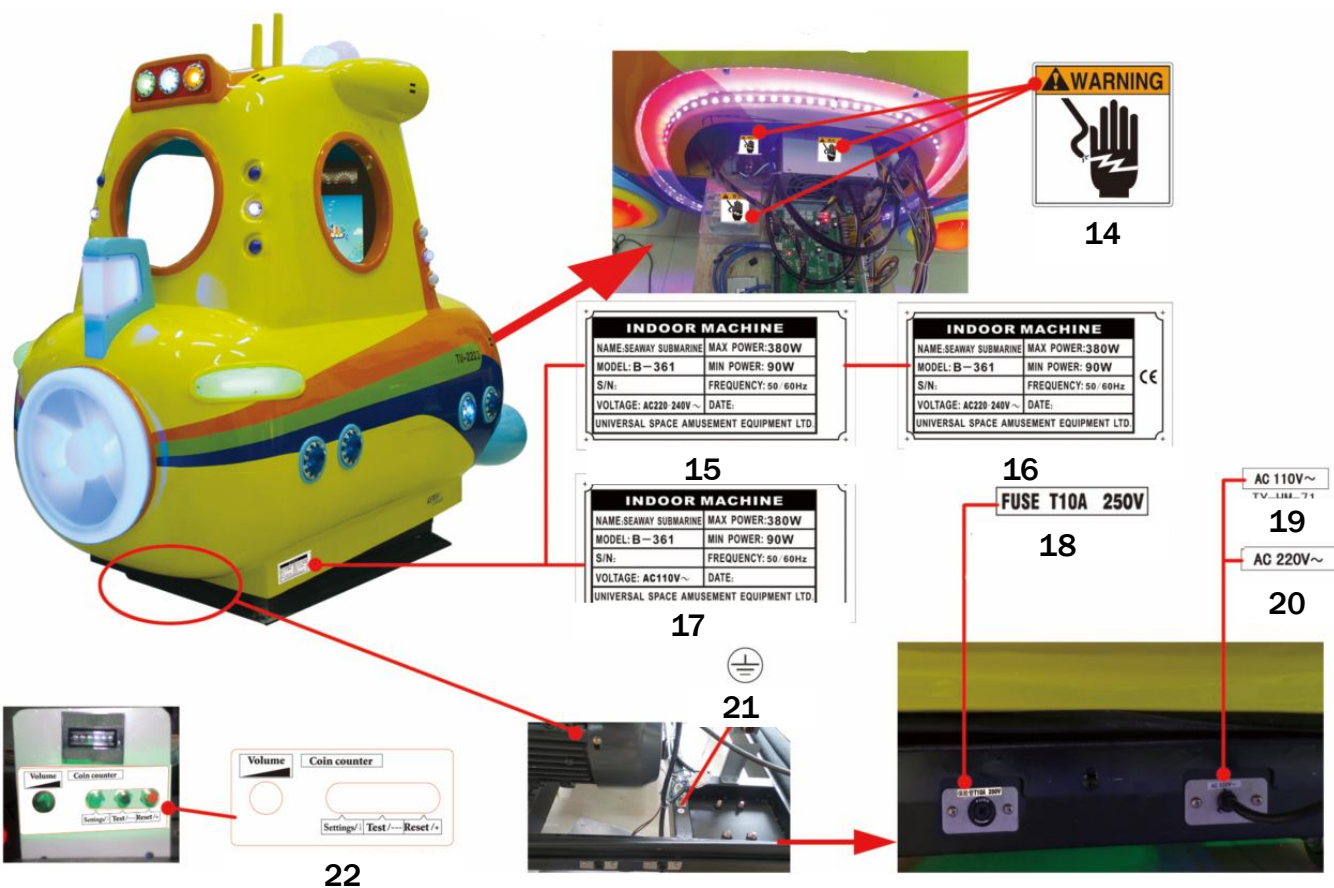



No.	Part No.	Code	Name	SPEC.	Qty
1	S119-701-000	20551302A001	Top light vacuum form	440X340X3	1
2	S119-715-000	20551302009	Front window decal		1
3	S119-711-000	20551302005	Meter decal		1
4	S119-703-000	20551302A003	Game play decal		1
5	S119-712-000	20551302006	Left side decal		1
6	S119-713-000	20551302007	Right side decal		1
7	S119-716-000	20551302010	Number decal		2
8	S119-717-000	20551302014	Catch fish button decal		1
9	S119-702-000	20551302A002	Control panel decal		1
10	S119-704-000	20551302A004	Logo decal		2
11	S119-710-000	20551302003	Headlight vacuum form cover		2
12	S119-709-000	20551302002	Front head vacuum form		1
13	S119-714-000	20551302008	Front small light plastic		3
14	S119-721-000	25600000036	Warning label		3
15	S119-707-000	20551302A007	Uncertified 220v nameplate		1
16	S119-708-000	20551302A008	CE certified 220V nameplate		1
17	S119-706-000	20551302A006	Uncertified 110v nameplate		1
18	S119-722-000	25600000077	Fuse label		1
19	S119-719-000	25600000071	110V label		1
20	S119-720-000	25600000072	220V label		1
21	S119-718-000	25600000091	GND label		1
22	S119-705-000	20551302A005	Counter label		1





Have Questions? Contact us!

www.universal-space.com

 International Support Center	 USA Support Center
<p>Tel: +1-905-477-2823 Fax: +1-905-477-2660 Email: service@universal-space.com (Contact: Clement Yau)</p>	<p>Tel: 972-241-4263 Fax: 214-919-4918 Email: tsnelling@unisusasupportcenter.com (Contact: Tim Snelling)</p>